

THE INFORMATION CONTAINED IN THIS DRAWING IS THE SOLE PROPERTY OF EASE ELECTRONICS. ANY REPRODUCTION IN PART OR WHOLE WITHOUT THE WRITTEN PERMISSION OF EASE ELECTRONICS IS PROHIBITED.

REV	DESCRIPTION	DATE	APPROVED
A	INITIAL RELEASE	6/7/25	CHILLY. L

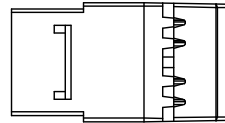
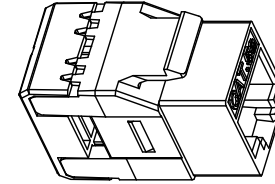
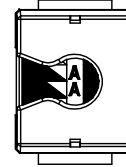
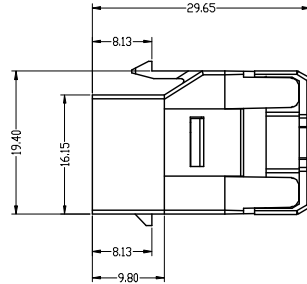
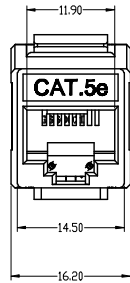
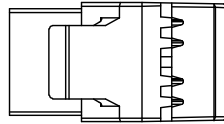

Part Number Table

PART NUMBER	DESCRIPTION	DWG. NO.
RJ45-5JU-180BK	Cat.5e RJ45 110 Type 180° Keystone Jack, Black	J0101
RJ45-5JU-180BL	Cat.5e RJ45 110 Type 180° Keystone Jack, Blue	J0102
RJ45-5JU-180GN	Cat.5e RJ45 110 Type 180° Keystone Jack, Green	J0103
RJ45-5JU-180GY	Cat.5e RJ45 110 Type 180° Keystone Jack, Gray	J0104
RJ45-5JU-180IV	Cat.5e RJ45 110 Type 180° Keystone Jack, Ivory	J0105
RJ45-5JU-180OR	Cat.5e RJ45 110 Type 180° Keystone Jack, Orange	J0106
RJ45-5JU-180RD	Cat.5e RJ45 110 Type 180° Keystone Jack, Red	J0107
RJ45-5JU-180WT	Cat.5e RJ45 110 Type 180° Keystone Jack, White	J0108
RJ45-5JU-180YW	Cat.5e RJ45 110 Type 180° Keystone Jack, Yellow	J0109

MATERIAL

Keystone Jack Housing: PC
 Insert Material: PBT
 PCB Material: FR-4 Thickness: 1.6mm
 Contact Material: Phosphor Bronze, Stamp Pin T=0.3mm
 IDC Contact Material: Phosphor Bronze T=0.5mm with Nickel Plating

PHYSICAL CHARACTERISTICS

Operating Temperature Range: -0 °C to 70 °C
 Storage Temperature Range: -40 °C to 85 °C
 Humidity: 10% ~ 90% RH
 Conform to TIA/EIA 568B.2
 Wire: AWG 23-24

ELECTRICAL

Voltage Rating: 125 VAC RMS.
 Current Rating: 1.5 AMP.
 Contact Resistance: 100 Milliohms Max.
 Insulation Resistance: 1000 Megohms Min @ 500 VDC.
 Dielectric Strength: 750 VAC RMS 60Hz, 1 Min.
 Conform to ANSI/TIA/EIA-568B.2

Mounting Type

Patch Panel, Faceplates/Wall Plates, Surface Mount Boxes

UNIT: MM

UNLESS OTHERWISE SPECIFIED, DIMENSIONS ARE IN INCHES [mm] OVERALL CABLE LENGTH TOLERANCE: ≤ 12 [305] = +1 [25] / -0 > 12 [305] ≤ 60 [1524] = +2 [51] / -0 > 60 [1524] ≤ 120 [3048] = +4 [102] / -0 > 120 [3048] ≤ 300 [7620] = +6 [152] / -0 > 300 [7620] = +5% / -0% ALL OTHER DIMENSIONAL TOLERANCES: .X = .3 .XX = .15 PROJECTION 	APPROVALS DRAWN BY LUKE. L CHECKED BY TILLY. H APPROVED BY CHILLY. L	DATE 5/7/2025 5/7/2025 6/7/2025	 Ease Electronics Co., Limited <small>Zone A, 2nd Floor, Bldg A, No.45, Qianjin 3rd Rd, Tanzhou, 528467 Zhongshan, Guangdong, China. +86-756-5888810</small> PART NUMBER <h2>RJ45-5JU-180YW</h2> PRODUCT DESCRIPTION <h3>Cat.5e RJ45 110 Type 180° Keystone Jack, Yellow</h3>				
	CONFIGURATION DETAILS OF UNDIMENSIONED FEATURES MAY VARY			ID J	SERIES NO. RJ45-J	DWG. NO. J0109	REV. J
	COLOR VARIATIONS MAY OCCUR			REF	SCALE: NONE	CAD FILE: J0109	SHEET 1 OF 1
	REF						