

RECOMMENDED HOLE PATTERN

RevNo	Revision Notes	Date	Checked
1	RoHS Compliant	092006	GC
2	MAX Male Pin Diameter range changed	040720	GC
3	MAX Male Pin Diameter reverted	040920	GC

RoHS Compliant

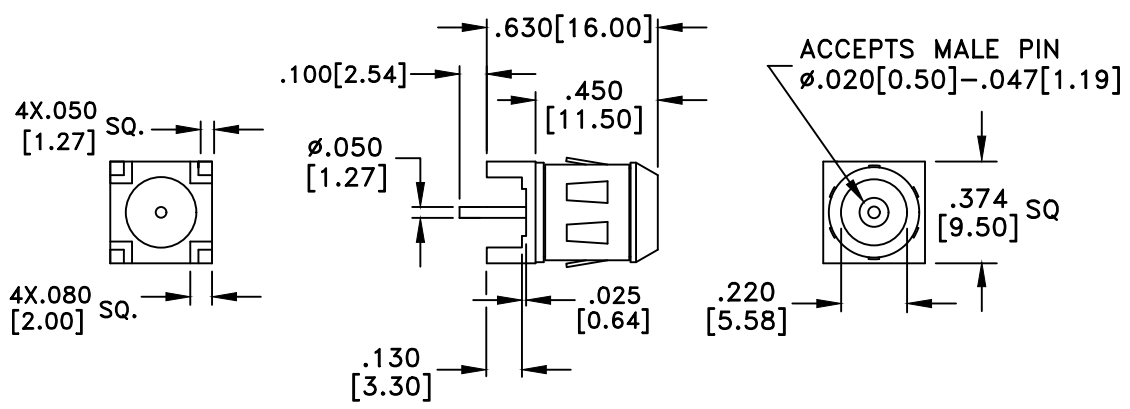

**MATERIALS**

BODY	BRASS
BODY PLATING	100u" BRIGHT ACID TIN OVER 10u" NICKEL
CONTACT	BRASS/BeCu
CONTACT PLATING	30u" GOLD
DIELECTRIC	TEFLON (PTFE)
CLIP	BERYLLIUM COPPER
CLIP PLATING	100u" BRIGHT ACID TIN OVER 10u" NICKEL

75 Ohm IMPEDANCE  
 500V PEAK VOLTAGE RATING  
 TEMPERATURE RANGE: -55°C TO +155°C  
 INTERFACE DIMENSIONS SIMILAR TO MIL-C-39012  
 500 MINIMUM MATING CYCLES  
 OPERATING MAXIMUM 15 AMPS  
 TEMPERATURE RANGE: -55°C TO +155°C  
 INTERFACE DIMENSIONS SIMILAR TO MIL-C-39012  
 1500V RMS DIELECTRIC WITHSTANDING VOLTAGE

MILLIMETER WAVE TECHNOLOGIES  
 6501 W. FRYE ROAD, #23  
 CHANDLER, AZ 85226

G FEMALE VERTICAL  
 PCB MOUNT  
 EXTENDED CONTACT

Designed by N. JAIN	Checked by W. CANON	Approved by A. LEE	File name MW-825-F15E	TITLE MW-825-F15E
DIMENSIONS IN INCHES UNLESS OTHERWISE SPECIFIED DECIMALS .XX ± .02 ANGULAR .XXX ± .005				ALL DIMENSIONS ON THIS DRAWING ARE FOR REFERENCE PURPOSES ONLY AND ARE SUBJECT TO CHANGE.
REV. 3 DATE 112801				Scale NONE Sheet 1 of 1